

Performance You Can Trust
أداء يمكنك الوثوق به

SUBMERSIBLE SEWAGE PUMP



Applications

- Municipal project.
- Industrial & Residential building.
- Mining .
- Civil engineering.

Application limits

- Max. liquid temperature : +40°C
- PH : 6.5 to 8.5
- Density of liquid : 1.3g/cm³
- Maximum immersion depth : 10M

Performance Range

- Capacity : up to 80 m³/hr
- Head : up to 45m
- Speed : 2900 rpm

Motor Details

- 2 Pole motor.
- Insulation class : F
- Motor protection : 7.5kW Built in
- Protection class : IP68
- Continues duty S1
- Power rating : 0.37kw to 5.5kw
- Cable length : 8 M
- Power supply :
Single phase 220V±10%,50Hz
Three phase 380V±10%,50Hz

Feature and Benefits

- Non-clogging double vane impeller can pump large solid cove full range of head.
- Chrome plated shaft ensure high corrosion resistance and wear resistance.
- Designed for pumping sewage, Waste water, Rainwater and living water containing solid grains, Various fabric, Sludge and solid.

Installation and Use

- This model of pump is characterized with high heads, Compact size, Light weight and convenient use and vastly used in high-position water delivery, Flush and places as construction sites. The float switch can automatically control on and off with the change of the water level. The protection in the motor can automatically cut off the power when it overheats or over current.

G.A Drawing

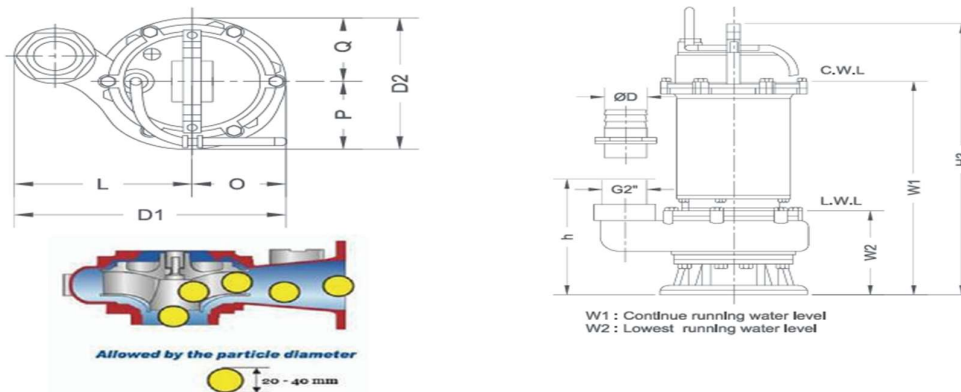

Dimension

Model	DIMENSIONS IN MM										
	D	H	W1	W2	W3	L	O	Q	P	D1	D2
TSP10-10-0.75F	50	200	315	120	450	115	90	90	96	241	186

G.A Drawing

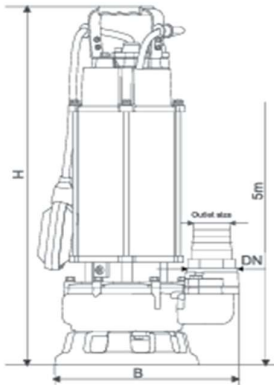

DIMENSION	TSP-05F	TSP10-10-0.75F
DN	G1.25"	1.5"
B	164	265
H	357	410

Pump Selection Chart

Model	Power		Voltage (50Hz)	Speed (RPM)	Outlet (Inch)	Guide Rail	Rated		Maximum		Impeller Passage	N.W. (Kg)
	KW	HP					Flow (M3/H)	Head (MTR)	Flow (M3/H)	Head (MTR)		
TSP-05F	0.37	0.5	220-240V	2900	1.25"	NO	4.5	4.5	9.0	7.0	15 MM	9.2
TSP10-10-0.75F	0.75	1.0	220-240V	2900	2"	NO	10.0	10.0	25.0	12.0	25 MM	21.3
TSP40-9-2.2	2.2	3.0	380-420V	2900	3"	80-80	40	9	65	16	30 MM	44.3
TSP40-18-4	4.0	5.5	380-420V	2900	3"	80-80	40	18	81	24	30 MM	59.2
TSP60-13-4	4.0	5.5	380-420V	2900	4"	100-100	60	13	93	24	30 MM	62.0
TSP15-40-5.5	5.5	7.5	380-420V	2900	2"	50-50	15	40	50	43	25 MM	73.0

Performance Chart

Model	Power		Q	US GPM																	
	KW	HP		M ³ /H																	
				0	5	10	15	20	25	30	35	40	45	50	60	65	70	75	80	90	
				LPM																	
				0	83	167	250	333	417	500	583	667	750	834	1000	1084	1167	1250	1334	1494	
TSP-05F	0.37	0.5	HEAD (MTR)	7	4																
TSP10-10-0.75F	0.75	1.0		12	11	9.5	8	6	4												
TSP40-9-2.2	2.2	3.0		16	15.5	14.5	13.5	12.5	11.5	10.5	9.5	8.5	7.5	6.5	4.5	3					
TSP40-18-4	4.0	5.5		24	23.5	23	22	21	20	19	18	17	16	15	12	10.5	9	7	4		
TSP60-13-4	4.0	5.5		24	23	22	21	20	19	18.5	18	17	16	15	12.5	10.5	9	7.5	6	3	
TSP15-40-5.5	5.5	7.5		43	42	41	39.5	38	36.5	34.5	32.5	30.5	28								

Performance curve

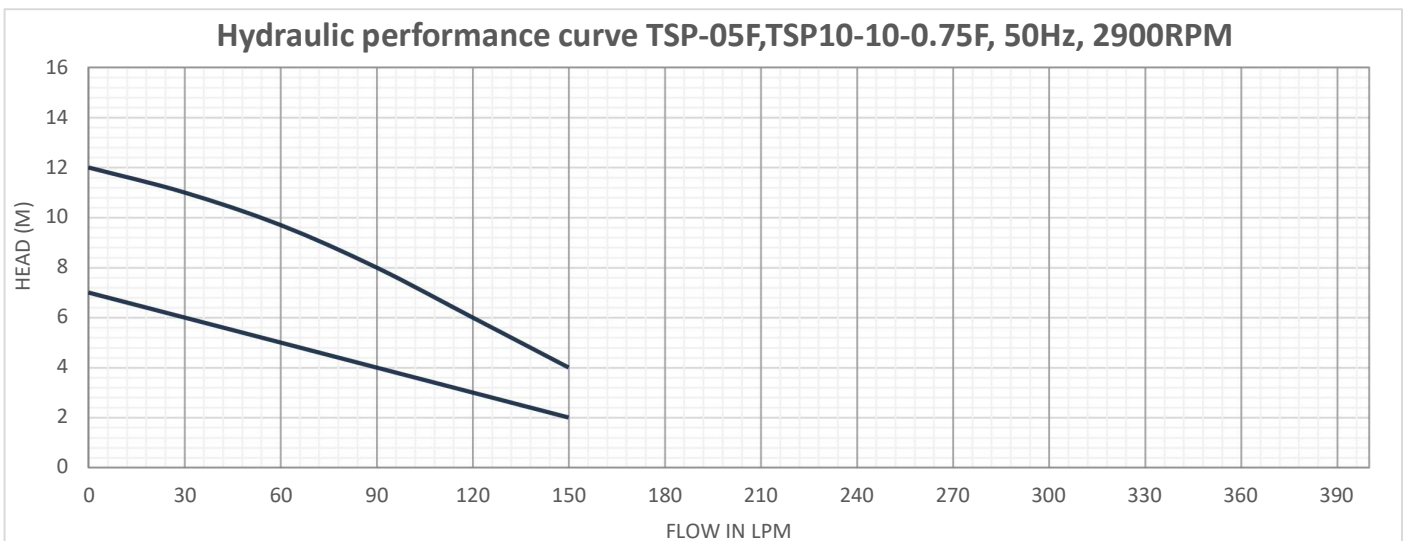

Performance curve

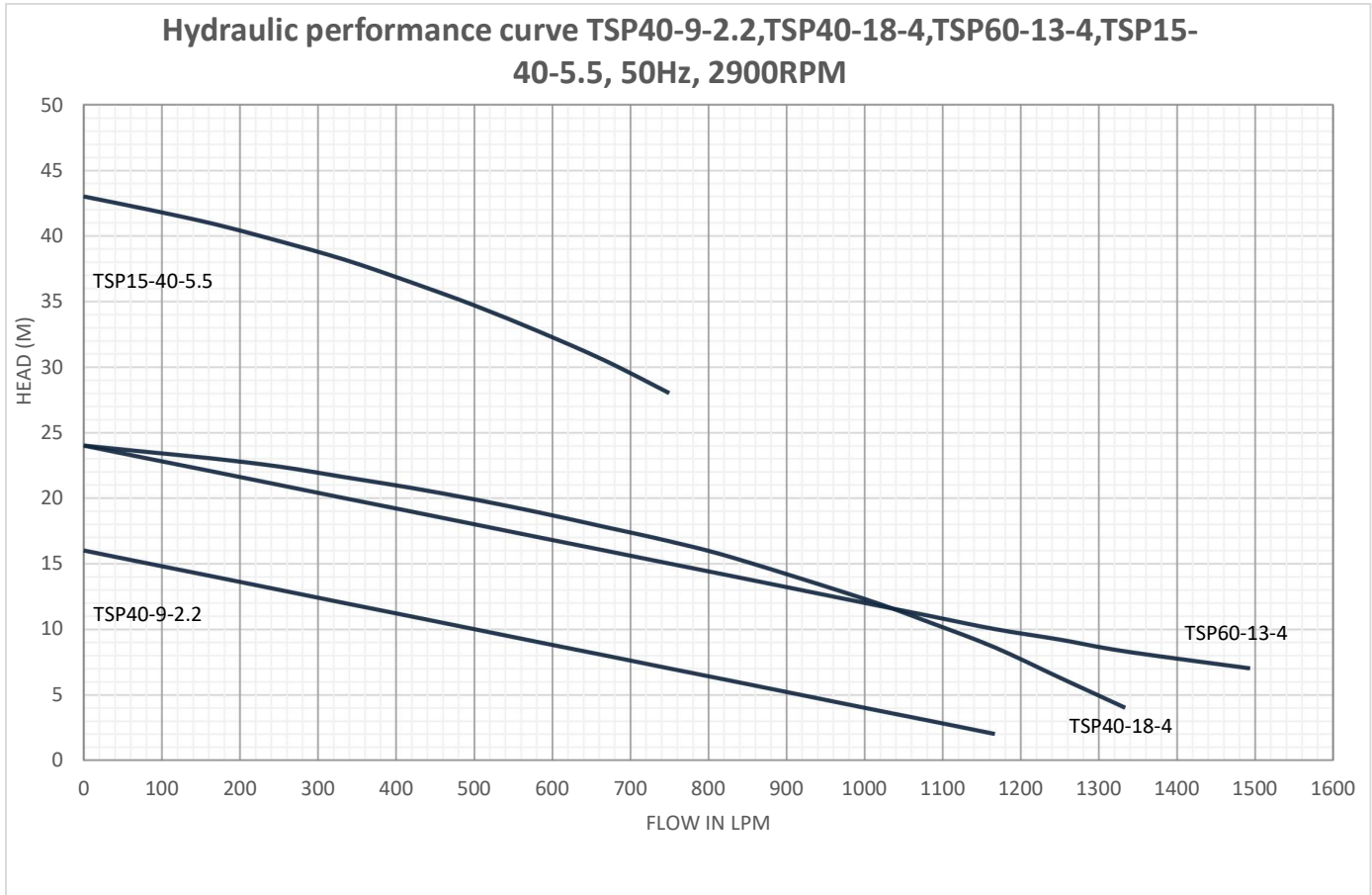

G.A Drawing

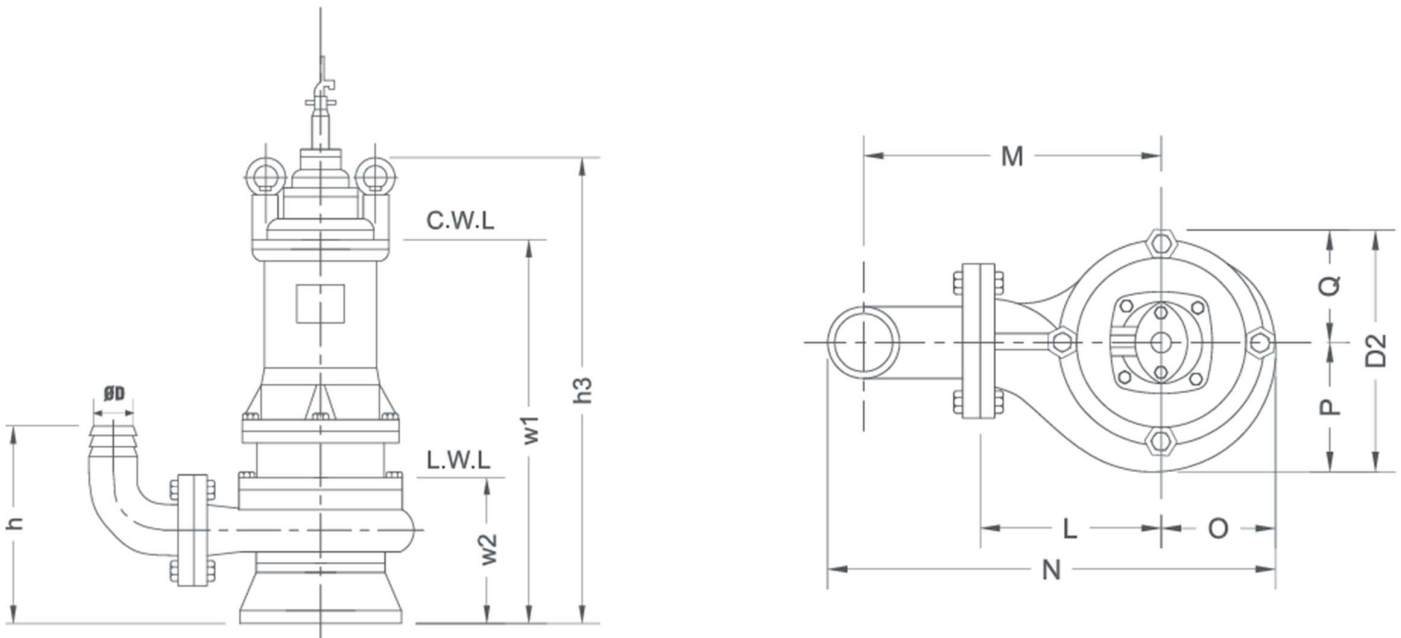

W1 : Continue running water level
W2 : Lowest running water level

Dimension

Model	DIMENSIONS IN MM											
	D	H	W1	W2	H3	N	O	P	Q	L	M	D2
TSP40-9-2.2	85	251	455	158	560	385	105	112	96	160	245	208
TSP40-18-4	80	272	528	195	640	375	105	112	98	150	230	210
TSP60-13-4	100	302	528	195	640	405	105	112	98	150	250	210
TSP15-40-5.5	50	237	523	165	645	390	120	125	115	180	245	240

Sectional view (TSP-05F, TSP10-10-0.75F)

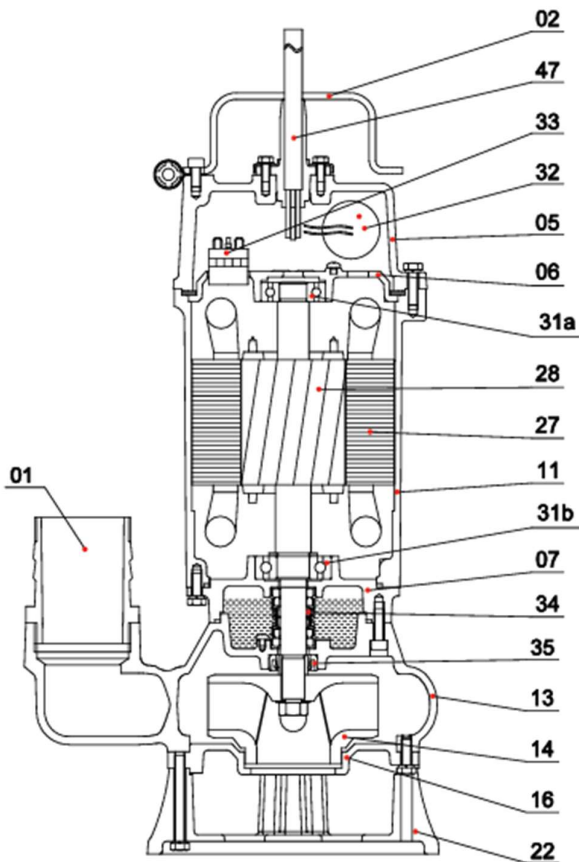

Item No.	Part Name	Material
01	Hose Coupling	Cast Iron
02	Handle	Steel
05	Upper Cover	Cast Iron
06	Up-Bearing House	Cast Iron
07	Bearing House	Cast Iron
11	Motor Body	Cast Iron
13	Pump Body	Cast Iron
14	Impeller	Cast Iron
16	Inlet Plate	Cast Iron
22	Seat Assembly	Cast Iron
27	Stator	Combination Part
28	Rotor	Shaft : AISI304SS
31a	Bearing	Ball Bearing
31b	Bearing	Ball Bearing
32	Capacitor	Combination Part
33	Motor Protector	Combination Part
34	Mechanical Seal	Sic-Ceramic / Carbon-Ceramic
35	Oil Seal	
47	Cable	

Materials of Construction (MOC)

Part Name	TSP-05F	TSP10-10-0.75F
Motor Housing	Stainless Steel	Stainless Steel (304)
Mechanical Seal	Graphite/Ceramics/SS304	Graphite/Ceramics/SS304
Impeller	PA66/30% Fiber	Stainless Steel (304)
Pump Casing	Cast Iron	Stainless Steel (304)

Sectional view (TSP40-9-2.2,TSP40-18-4,TSP60-13-4,TSP15-40-5.5)

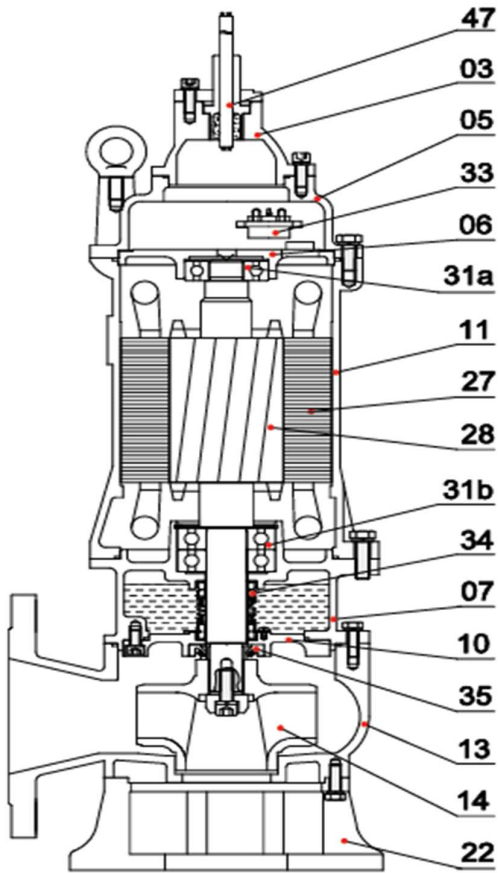

Item No.	Part Name	Material
01	Hose Coupling	Cast Iron
01a	Hose Coupling	Cast Iron
03	Terminal Box	Cast Iron
05	Upper Cover	Cast Iron
06	Up-Bearing House	Cast Iron
07	Bearing House	Cast Iron
10	Seal Bracket	Cast Iron
11	Motor Body	Cast Iron
13	Pump Body	Cast Iron
14	Impeller	Cast Iron
17	Coupling Adaptor	Ductile Iron
22	Seat Assembly	Cast Iron
22a	Coupling Seat	Cast Iron
22b	Upper Guild Support	Cast Iron
27	Stator	Cast Iron
28	Rotor	Shaft : AISI304SS
30	Flange	Cast Iron
31a	Bearing	Ball Bearing
31b	Bearing	Ball Bearing
33	Motor Protector	
34	Mechanical Seal	Sic-Ceramic / Carbon-Ceramic
35	Oil Seal	
37	Cable	

Sewage pump Guide Rail System Details

G.A. Drawing

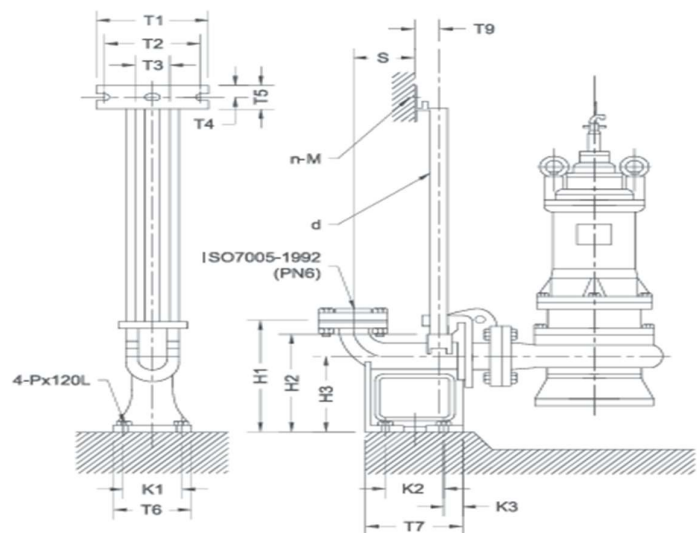
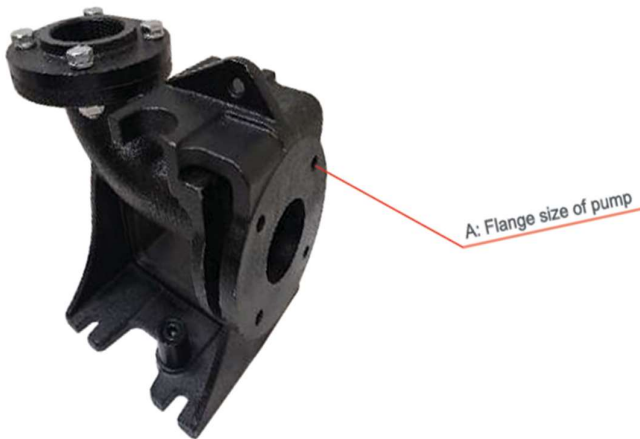

Model	T1	T2	T3	T4	T5	T6	T7	T8	T9	K1	K2	K3	S	H1	H2	H3	D	n-M	P	A
50-50	288	185	70	25	63	160	200	10	50	120	120	40	125	250	203	170	25	2-M10X40	M16	Ø110/4-Ø10
80-80	288	195	80	25	63	220	250	15	60	170	170	40	165	290	242	192	32	2-M10X40	M16	Ø150/4-Ø18
100-100	410	315	170	30	60	320	385	17	90	260	300	48	200	305	245	200	32	2-M12X50	M18	Ø170/4-Ø18

 **texmo**
pump



DISTRIBUTOR OFFICE MIDDLE EAST

MAJESTIC PRIDE GENERAL TRADING LLC

Shk. Zayad Road–Dubai–UNITED ARAB ENMIRATES

E-mail :- info@texmopump.ae , sales@texmopump.ae

Mob.no. :- +971 566813779 / +971 528716531

DISTRIBUTOR OFFICE FOR OMAN

MAJESTIC PRIDE INTERNATIONAL LLC

Barka,Suwaq,Mubaila,Muscat–Sultanate of Oman

E-mail :- oman@texmopump.ae

Mob.no. :- +968 78839511 / +968 96627632

Website :- www.texmopump.ae
Instagram :- [texmopump.ae](https://www.instagram.com/texmopump.ae)

